

**TRAFFIC SWINGING SINGLE LEAF DOORS WITH TORSION HINGES**

ALL PRICES IN US DOLLARS, 2 MM THICK DOOR FRAME INCLUDED, VAT NOT INCLUDED

(TSD TH)

26.03.2025

- PH Insulation's traffic swinging doors are designed to separate production and other premises in places with intensive traffic of personnel. The factory-made doors are ready for installation on technological, industrial premises, supermarkets, hospitals, food production facilities, cafes, restaurants, etc. Doors can be equipped with oval windows of 200x500 or 300x580 mm.
- PH Insulation's doors with torsion hinges automatically return to the closed position and remain closed even in strong wind.
- All elements of torsion hinges are made of steel.
- Torsion hinges are less visible in the interior compared to standard hinges.
- Important! Doors with torsion hinges should be used only in dry areas.

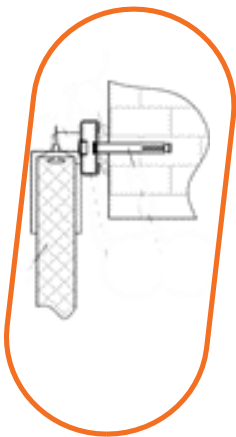

**OVERHEAD FRAME**

INSTALLATION OPENING, HEIGHT, MM	INSTALLATION OPENING, WIDTH, MM						
	700	800	900	1000	1100	1200	1300
1800	479	490	498	512	521	540	623
1900	484	496	505	519	528	615	630
2000	488	502	511	526	535	622	638
2100	493	508	518	532	607	629	646
2200	498	515	524	539	614	637	653
2300	508	527	536	617	628	651	737
2400	518	538	548	630	641	665	753
2500	606	622	633	651	663	688	778
2600	620	637	649	667	679	775	795
2700	627	646	658	677	689	785	806
2800	635	655	667	686	767	795	816
2900	711	729	742	763	777	806	828
3000	719	740	754	775	789	818	841
3100	727	750	764	785	800	830	852
3200	736	760	774	796	811	842	864
3300	742	768	782	805	819	851	874

RAL 9003

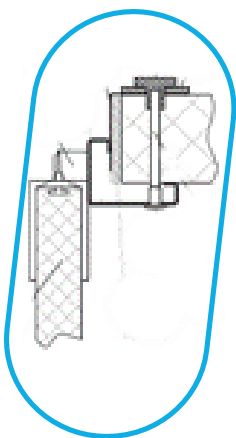

**ANGULAR FRAME**

INSTALLATION OPENING, HEIGHT, MM	INSTALLATION OPENING, WIDTH, MM						
	700	800	900	1000	1100	1200	1300
1800	529	540	550	562	574	595	680
1900	534	547	557	570	582	671	688
2000	545	560	570	583	596	686	704
2100	551	567	577	591	670	694	713
2200	557	574	585	598	678	703	721
2300	573	592	603	683	697	723	813
2400	584	605	616	698	712	739	829
2500	669	685	698	714	729	756	848
2600	681	698	711	728	743	840	863
2700	689	708	721	738	753	852	874
2800	697	718	731	748	832	863	886
2900	779	798	812	830	847	879	902
3000	789	812	826	845	862	895	918
3100	798	821	836	855	873	906	930
3200	806	831	846	865	883	916	941
3300	814	841	856	876	894	928	953

RAL 9003

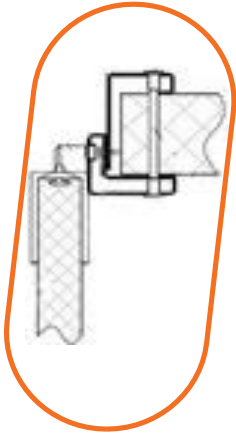

## OVERLAPPING FRAME

INSTALLATION OPENING, HEIGHT, MM	INSTALLATION OPENING, WIDTH, MM						
	700	800	900	1000	1100	1200	1300
1800	606	621	632	647	664	685	763
1900	615	631	643	658	675	768	775
2000	630	648	660	676	693	787	795
2100	638	658	671	687	774	799	807
2200	647	669	681	698	785	811	819
2300	666	689	702	788	808	834	914
2400	681	706	720	807	827	854	936
2500	782	802	817	836	857	885	967
2600	797	819	834	854	875	977	986
2700	809	833	848	868	890	992	1001
2800	821	846	862	882	976	1007	1017
2900	908	931	948	970	993	1025	1035
3000	925	951	969	991	1015	1048	1058
3100	937	965	983	1005	1030	1063	1073
3200	946	975	993	1016	1041	1074	1085
3300	958	989	1007	1030	1055	1089	1100

RAL 9003

ALL DOORS ARE AVAILABLE IN CUSTOM SIZES TO INSURE BEST COMMERCIAL APPLICATION

## TRAFFIC SWINGING DOUBLE LEAF DOORS WITH TORSION HINGES

ALL PRICES IN US DOLLARS, 2 MM THICK DOOR FRAME INCLUDED, VAT NOT INCLUDED

(TDD TH)

26.03.2025

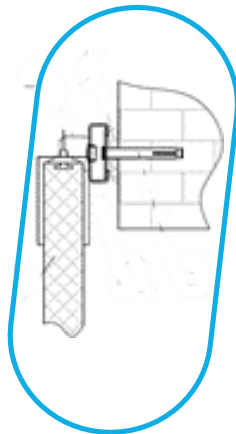

## OVERHEAD FRAME

INSTALLATION OPENING, HEIGHT, MM	INSTALLATION OPENING, WIDTH, MM				
	1000	1100	1200	1300	1400
1800	735	739	751	755	820
1900	743	747	759	763	831
2000	751	755	767	771	843
2100	758	763	775	779	855
2200	766	770	782	787	866
2300	782	787	799	803	887
2400	799	804	819	824	913
2500	937	943	958	963	1055
2600	958	964	979	984	1080
2700				997	1097
2800				1010	1113
2900				1154	1261
3000				1167	1278
3100				1181	1297
3200				1196	1316
3300				1207	1331

RAL 9003

## OVERHEAD FRAME

	INSTALLATION OPENING, HEIGHT, MM	INSTALLATION OPENING, WIDTH, MM				
		1500	1600	1700	1800	1900
RAL 9003	1800	823	827	831	834	840
	1900	835	839	843	846	852
	2000	847	851	855	859	865
	2100	859	863	867	871	877
	2200	871	875	879	883	890
	2300	892	896	901	905	1041
	2400	917	922	926	931	1068
	2500	1060	1064	1069	1074	1081
	2600	1085	1090	1095	1100	1108
	2700	1102	1107	1112	1118	1125
	2800	1119	1124	1129	1135	1142
	2900	1267	1272	1278	1283	1291
	3000	1283	1289	1295	1300	1308
	3100	1303	1309	1315	1321	1329
	3200	1322	1328	1334	1340	1348
	3300	1337	1344	1350	1356	1364

## OVERHEAD FRAME

	INSTALLATION OPENING, HEIGHT, MM	INSTALLATION OPENING, WIDTH, MM						
		2 000	2 100	2 200	2 300	2 400	2 500	2 600
RAL 9003	1800	844	847	851	854	860	992	995
	1900	856	860	864	867	873	1001	1005
	2000	869	873	877	881	887	1010	1014
	2100	882	1013	1017	1022	1028	1032	1036
	2200	894	1026	1030	1035	1041	1046	1050
	2300	1046	1050	1055	1059	1065	1200	1204
	2400	1073	1078	1083	1087	1094	1229	1234
	2500	1086	1091	1096	1100	1107	1243	1248
	2600	1113	1118	1123	1129	1135	1266	1271
	2700	1130	1136	1141	1147	1153	1290	1295
	2800	1148	1154	1159	1165	1171	1308	1313
	2900	1297	1302	1308	1313	1321	1327	1332
	3000	1314	1320	1326	1331	1339	1345	1351
	3100	1335	1341	1347	1353	1361	1367	1373
	3200	1355	1360	1367	1373	1381	1387	1393
	3300	1371	1377	1383	1389	1398	1404	1410

## ANGULAR FRAME

	INSTALLATION OPENING, HEIGHT, MM	INSTALLATION OPENING, WIDTH, MM				
		1000	1100	1200	1300	1400
RAL 9003	1800	780	787	798	802	870
	1900	789	795	807	811	883
	2000	797	804	816	820	895
	2100	806	812	825	829	908
	2200	822	829	842	846	929
	2300	844	851	864	869	956
	2400	863	870	886	891	983
	2500	999	1007	1023	1028	1123
	2600	1018	1026	1042	1047	1145
	2700				1061	1163
	2800				1075	1180
	2900				1224	1333
	3000				1240	1353
	3100				1254	1372
	3200				1267	1390
	3300				1281	1407

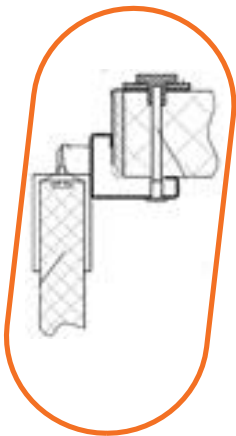

## ANGULAR FRAME

	INSTALLATION OPENING, HEIGHT, MM	INSTALLATION OPENING, WIDTH, MM				
		1500	1600	1700	1800	1900
RAL 9003	1800	874	878	882	886	892
	1900	887	891	895	899	905
	2000	899	903	908	912	918
	2100	912	916	921	925	932
	2200	934	938	943	948	955
	2300	961	966	970	975	1113
	2400	988	993	998	1003	1142
	2500	1128	1133	1138	1144	1151
	2600	1151	1156	1162	1167	1175
	2700	1169	1174	1180	1185	1193
	2800	1186	1192	1198	1204	1212
	2900	1339	1345	1351	1357	1365
	3000	1359	1365	1371	1377	1385
	3100	1379	1385	1391	1398	1406
	3200	1396	1403	1409	1415	1424
	3300	1414	1420	1427	1434	1443

## ANGULAR FRAME

	INSTALLATION OPENING, HEIGHT, MM	INSTALLATION OPENING, WIDTH, MM						
		2 000	2 100	2 200	2 300	2 400	2 500	2 600
RAL 9003	1800	898	902	906	910	916	1050	1054
	1900	911	916	920	1052	1058	1064	1068
	2000	925	929	933	1066	1072	1079	1083
	2100	938	1071	1075	1079	1086	1093	1097
	2200	961	1095	1100	1104	1111	1118	1123
	2300	1120	1125	1130	1134	1141	1279	1284
	2400	1149	1154	1159	1164	1172	1311	1316
	2500	1159	1164	1169	1175	1182	1320	1325
	2600	1183	1188	1194	1330	1337	1345	1350
	2700	1201	1207	1212	1349	1356	1364	1370
	2800	1220	1356	1362	1368	1376	1384	1389
	2900	1374	1379	1385	1391	1399	1408	1414
	3000	1394	1400	1406	1412	1421	1429	1435
	3100	1415	1421	1427	1434	1442	1451	1457
	3200	1433	1439	1446	1452	1461	1470	1476
	3300	1452	1458	1465	1471	1480	1489	1496

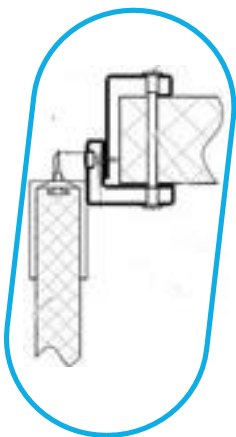

## OVERLAPPING FRAME

	INSTALLATION OPENING, HEIGHT, MM	INSTALLATION OPENING, WIDTH, MM				
		1000	1100	1200	1300	1400
RAL 9003	1800	860	867	880	886	956
	1900	873	880	894	900	974
	2000	887	894	908	913	991
	2100	899	906	920	926	1008
	2200	915	922	937	943	1029
	2300	938	945	960	967	1057
	2400	965	973	991	998	1093
	2500	1093	1101	1118	1125	1221
	2600	1115	1123	1140	1148	1248
	2700				1165	1268
	2800				1183	1291
	2900				1335	1446
	3000				1357	1472
	3100				1374	1495
	3200				1388	1513
3300				1405	1534	

## OVERLAPPING FRAME

	INSTALLATION OPENING, HEIGHT, MM	INSTALLATION OPENING, WIDTH, MM				
		1500	1600	1700	1800	1900
RAL 9003	1800	962	967	973	978	986
	1900	979	985	991	996	1004
	2000	997	1003	1009	1015	1023
	2100	1014	1020	1026	1032	1040
	2200	1035	1041	1047	1054	1062
	2300	1064	1070	1076	1083	1226
	2400	1100	1106	1113	1120	1266
	2500	1228	1235	1242	1249	1258
	2600	1255	1262	1269	1276	1285
	2700	1276	1283	1290	1297	1307
	2800	1298	1305	1313	1320	1330
	2900	1454	1462	1469	1477	1486
	3000	1480	1488	1495	1503	1513
	3100	1503	1511	1519	1527	1537
	3200	1521	1529	1537	1545	1556
	3300	1542	1550	1559	1567	1577

## OVERLAPPING FRAME

	INSTALLATION OPENING, HEIGHT, MM	INSTALLATION OPENING, WIDTH, MM						
		2 000	2 100	2 200	2 300	2 400	2 500	2 600
RAL 9003	1800	992	998	1003	1009	1016	1155	1161
	1900	1011	1017	1022	1160	1168	1175	1181
	2000	1030	1036	1041	1180	1188	1195	1201
	2100	1048	1186	1192	1198	1207	1214	1220
	2200	1069	1209	1215	1222	1230	1237	1244
	2300	1234	1240	1247	1253	1262	1405	1411
	2400	1273	1280	1287	1293	1302	1447	1454
	2500	1266	1273	1280	1286	1296	1436	1443
	2600	1293	1300	1307	1447	1456	1464	1472
	2700	1315	1322	1330	1469	1479	1487	1494
	2800	1338	1478	1486	1493	1503	1511	1519
	2900	1495	1503	1510	1518	1528	1536	1544
	3000	1522	1530	1538	1546	1556	1565	1572
	3100	1546	1554	1562	1570	1580	1590	1598
	3200	1565	1573	1581	1589	1599	1609	1617
	3300	1587	1595	1603	1611	1622	1631	1639

ALL DOORS ARE AVAILABLE IN CUSTOM SIZES TO INSURE BEST COMMERCIAL APPLICATION

## DOOR CATALOGUE CODES

TSD TH	TRAFFIC SWINGING SINGLE LEAF DOORS WITH TORSION HINGES
TDD TH	TRAFFIC SWINGING DOUBLE LEAF DOORS WITH TORSION HINGES
RIGHT / LEFT	HINGES ON THE RIGHT / HINGES ON THE LEFT

### EXAMPLE OF DOOR CATALOGUE CODE: TSD TH 800 2000 40 RAL9003/RAL9003 ANG RIGHT

DOOR TYPE	DOORWAY WIDTH	DOORWAY HEIGHT	DOOR THICKNESS	DOOR LEAF METAL		FRAME TYPE	HINGES LOCATION
				EXTERIOR	INTERIOR		
TSD TH	800	2 000	40	RAL9003	RAL9003	ANGULAR	RIGHT

## ADDITIONAL OPTIONS FOR TRAFFIC SWINGING DOORS

ITEM	PRICE
TDD FRAME INSTALLATION HARDWARE TO INSULATED SANDWICH PANELS	15
TSD FRAME INSTALLATION HARDWARE TO INSULATED SANDWICH	11
TDD FRAME INSTALLATION HARDWARE TO A BRICK WALL	10
TSD FRAME INSTALLATION HARDWARE TO A BRICK WALL	5
FRAME INSTALLATION HARDWARE FOR STEEL STUD CONSTRUCTION	3
DOOR BLADE MATERIAL: AISI 304, PRICE FOR 1 SQ. M	40
DOOR BLADE MATERIAL: AISI 430, PRICE FOR 1 SQ. M	27
OVERHEAD FRAME AISI 304, PRICE FOR RUNNING METER	22
ANGULAR FRAME AISI 304, PRICE FOR RUNNING METER	38
OVERLAPPING FRAME AISI 304, PRICE FOR RUNNING METER	99
OVERHEAD FRAME AISI 430, PRICE FOR RUNNING METER	13
ANGULAR FRAME AISI 430, PRICE FOR RUNNING METER	22
OVERLAPPING FRAME AISI 430, PRICE FOR RUNNING METER	57
HIDDEN INSTALLATION HARDWARE FOR TSD	54
HIDDEN INSTALLATION HARDWARE FOR TDD	64
HIDDEN INSTALLATION HARDWARE FOR TSD WITH AISI 304 FRAME	74
HIDDEN INSTALLATION HARDWARE FOR TDD WITH AISI 304 FRAME	88
HIDDEN INSTALLATION HARDWARE FOR TSD WITH AISI 430 FRAME	66
HIDDEN INSTALLATION HARDWARE FOR TDD WITH AISI 304 FRAME	78

## FACTORY INSTALLED BUMPERS FOR TSD TH

BUMPER MATERIAL	THICKNESS, MM	PRICE FOR SQ. M	PRICE FOR RUNNING METER	
			BOTTOM 0,25 M	BOTTOM 0,5 M
AISI 304	1,5	133	33	66
AISI 430	1,5	88	22	44
ALUMINIUM CHECKER PLATE	1,5	70	17	35
FLAT HDPE PLASTIC	4,0	40	10	20
CURVED HDPE PLASTIC	6,0	57	14	29

## FACTORY INSTALLED BUMPERS FOR TDD TH

BUMPER MATERIAL	THICKNESS, MM	PRICE FOR SQ. M	PRICE FOR RUNNING METER	
			BOTTOM 0,25 M	BOTTOM 0,5 M
AISI 304	1,5	139	35	70
AISI 430	1,5	91	23	46
ALUMINIUM CHECKER PLATE	1,5	74	18	37
FLAT HDPE PLASTIC	4,0	41	10	20
CURVED HDPE PLASTIC	4,0	47	12	23
CURVED HDPE PLASTIC	6,0	58	15	29

## PACKAGING

ITEM	PRICE
STRETCH-WRAP	INCLUDED IN DOOR PRICE
CARDBOARD PACKAGING	CALCULATED INDIVIDUALLY FOR YOUR ORDER
WOODEN PACKAGING	CALCULATED INDIVIDUALLY FOR YOUR ORDER

